

Pullman

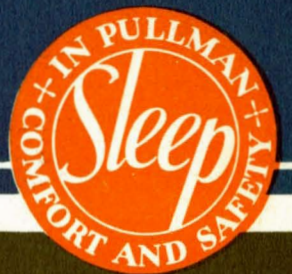

Accommodations



Foreword + + +

This book tells the story of Pullman travel service, describing each type of individual accommodation from upper berth to drawing-room, and pointing out many added conveniences which round out Pullman comfort to the full. The cost of these Pullman accommodations is also indicated.

Pullman service is available between all major terminals in the United States, Canada and Mexico. To provide this service there are Pullman cars of all types rolling across the country in every direction, or standing equipped and ready in railroad yards awaiting call. There is a balanced and well matched equipment for all trains, an adequate reserve supply of equipment to meet peak demands. Through its unified, international system The Pullman Company is able to shift its cars in season, increasing the supply the country over for holidays, for winter traffic to Florida and California, for spring traffic to the Virginias and Carolinas, for summer traffic to lakes, mountains and seashore—everywhere.

When you have finished reading this book you will have a new and more complete understanding of the luxury of Pullman travel.

The Upper Berth

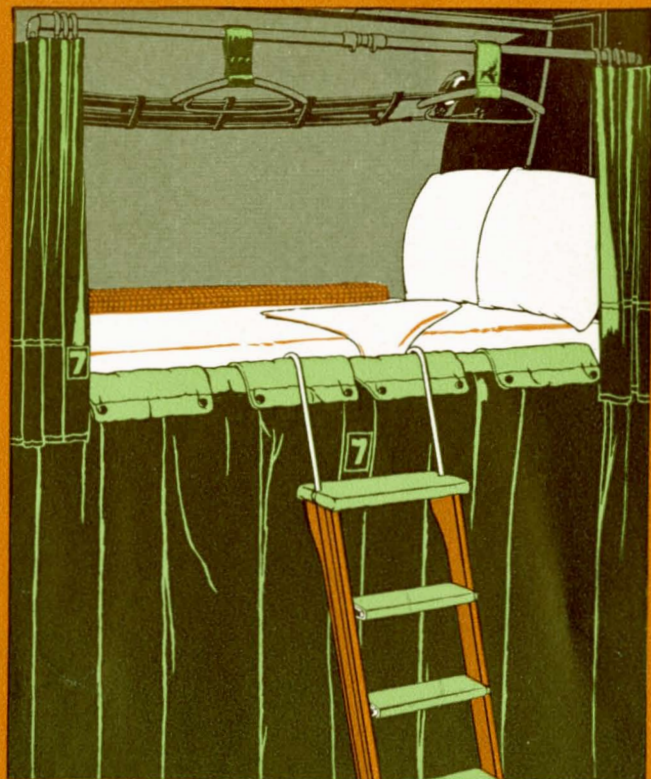
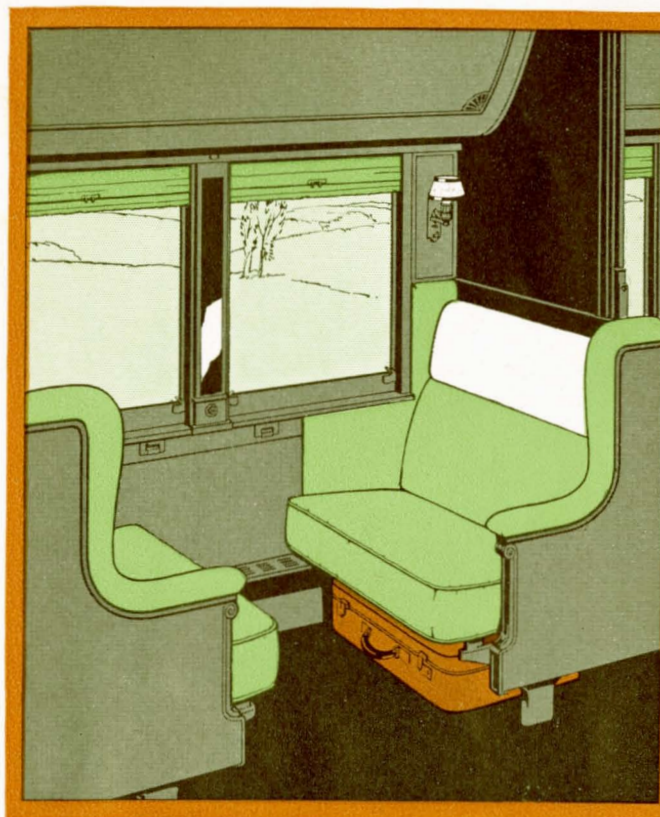

An upper berth provides commodious accommodations, with electric lights, a flexible shelf 4 feet long and 7½ inches wide to hold luggage or clothing, a hanger for your clothes, and electric bell with which to summon porter at any hour. A safety ladder makes access and exit easy. The upper has a horsehair mattress with spring base, forming a bed over 6 feet in length and 35 inches wide. Each of the two pillows contains 21½ pounds of goose-feathers. For daytime travel each seat in the section contains ample room for

two passengers. Porter will install sturdy table for writing or for games, if desired. At night the upper accommodates one or two adults. The upper berth is the lowest priced accommodation in a Pullman car. In some parts of the country tourist sleeping cars are operated. The preceding description applies in a general way to a tourist upper, but the price of the latter is considerably lower. Naturally, it lacks some of the refinements of a standard upper, yet there is always to be found a full measure of Pullman comfort and convenience.

UPPER BERTH—TARIFF: Railroad transportation required: for an adult—1 rail ticket; for a child (5 to 12 inclusive)—one-half fare rail ticket. The charge for an upper berth is 20% less than that for a lower berth.

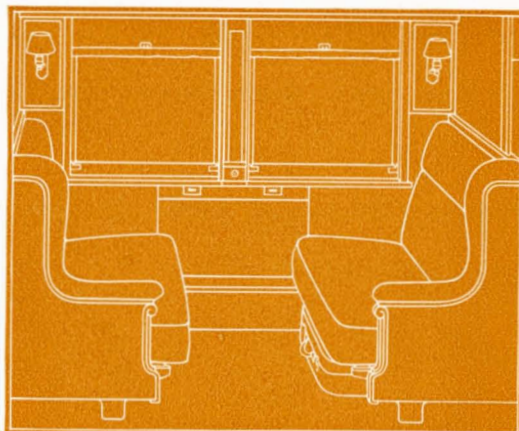

THE UPPER BERTH—(Illustration: view from aisle)—DIMENSIONS: Length 6 feet, 2 inches; width 35 inches. Mattress: horsehair with spring base. Luggage space under seat: height 9 inches, depth 16½ inches, length 28½ inches.

The Lower Berth

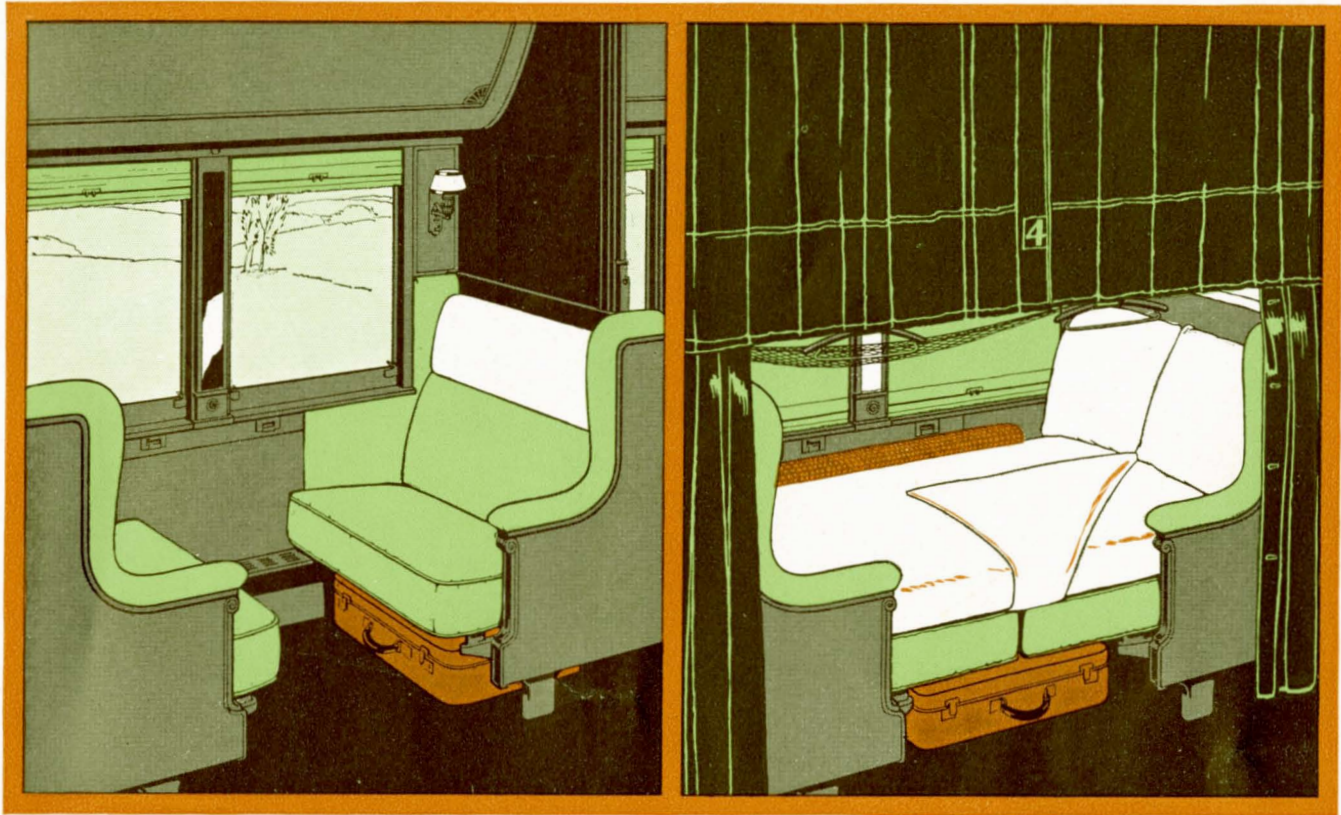

A lower berth is furnished with electric lights, shelf for luggage, hammock for clothes, a hanger for your clothes, and electric bell with which to summon porter at any hour. The spring mattress has $6\frac{1}{2}$ pounds of the finest horsehair, is $4\frac{1}{2}$ inches thick. Each of the two pillows contains $2\frac{1}{2}$ pounds of the finest goose-feathers. The length of the bed between head boards is 6 feet, 2 inches, and its width 35 inches. Under the bed is baggage space for suitcases not to exceed 9 by $28\frac{1}{2}$ inches. For daytime travel the passenger holding the lower berth is en-

titled to the seat facing forward; each seat contains ample room for two passengers. Porter will install sturdy table for writing or for games, if desired. At night, the lower accommodates one or two adults. Whatever the accommodation, Pullman attempts always to bring to every traveler the comforts and conveniences to which he is accustomed at home. The tourist sleeping car, operated in some parts of the country, has lower berths similar to those in standard cars, but, as the cost to the passenger is less, there are fewer conveniences.

LOWER BERTH—TARIFF: *Railroad transportation required: for an adult—one rail ticket; for a child (5 to 12 inclusive)—one-half fare rail ticket. The charge for a lower berth depends, of course, upon your destination, and is the basis for the charges for all other accommodations.*

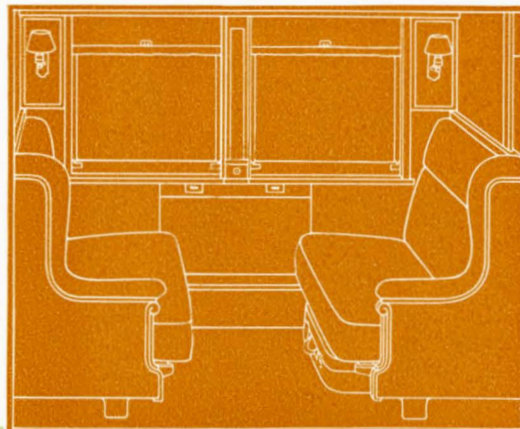

LOWER BERTH—(at left: view from aisle)—DIMENSIONS: Length 6 feet, 2 inches; width 35 inches. Mattress, spring type. Luggage space under seat: height 9 inches, depth $16\frac{1}{2}$ inches, length $28\frac{1}{2}$ inches. Window opening: width $24\frac{7}{8}$ inches, height $16\frac{3}{4}$ inches.

The Section

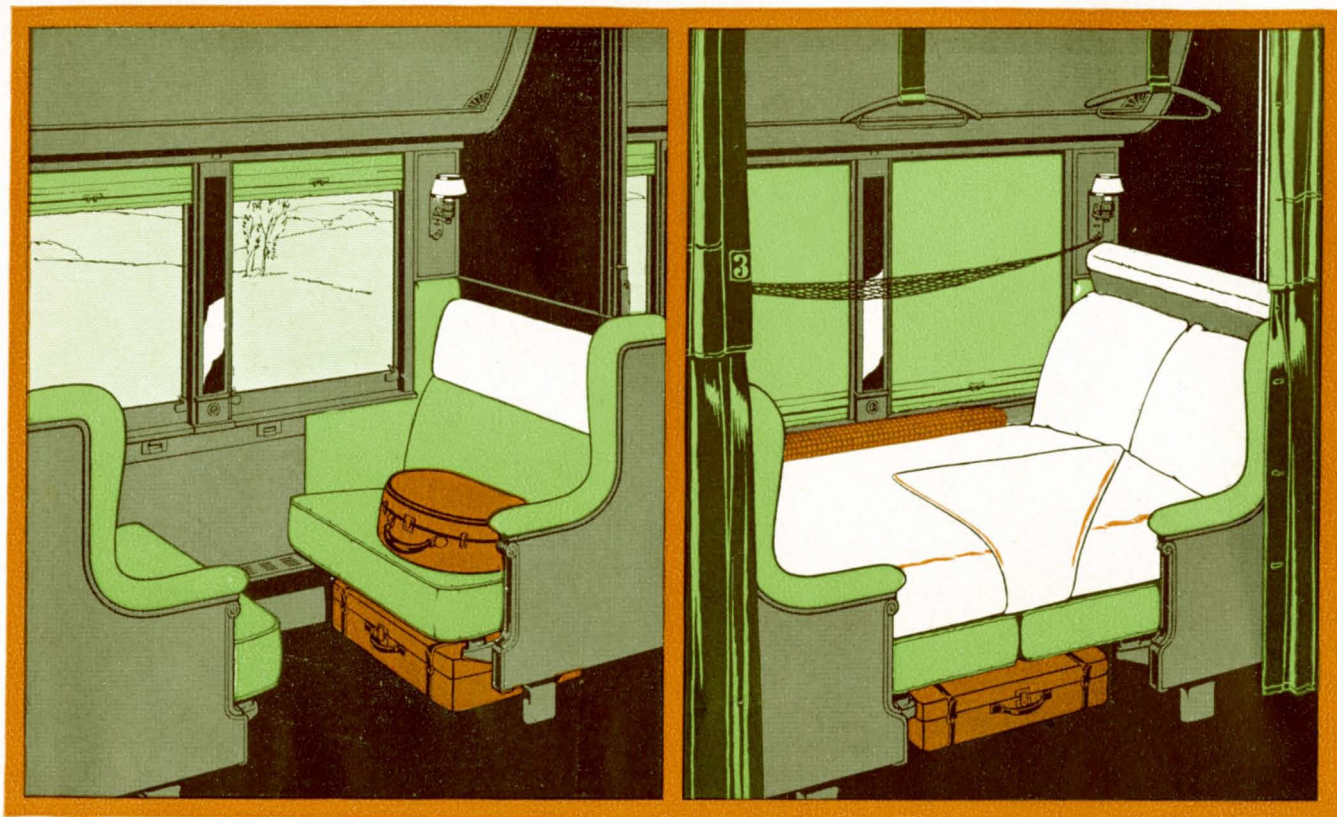

The section is the combination of an upper and lower berth. When a section is reserved for two travelers it is called a "double occupancy section"; for a single traveler it is called a "single occupancy section" and the upper is not made down. It is furnished with electric lights, shelf for luggage, hammock for clothes, a coat, skirt or suit hanger, and electric bell with which to summon porter at any hour. Both upper and lower mattresses are available when the section has but a single occupant, giving a total mattress depth of 9 inches. With the

upper pushed up, the traveler has 6 feet, $2\frac{1}{4}$ inches of additional space in which to undress and make his preliminary toilet. The length of the bed between headboards is 6 feet, 2 inches, and the width 35 inches. Under the bed is baggage space for suitcases 9 inches high by $28\frac{1}{2}$ inches long. By day, the occupant of a section is entitled to the use of both seats for lounging or for luggage. Porter will install a table for writing or games, if desired. The "single occupancy section" is the favorite accommodation of many Pullman travelers.

THE SECTION—TARIFF: Railroad transportation required: for an adult—one rail ticket; for a child (5 to 12 inclusive)—one-half rail ticket. Pullman rate for section for one passenger or one passenger and child under 12 years — lower berth rate plus one-half upper berth rate. For two adult passengers — lower berth rate plus three-fourths of upper berth rate.

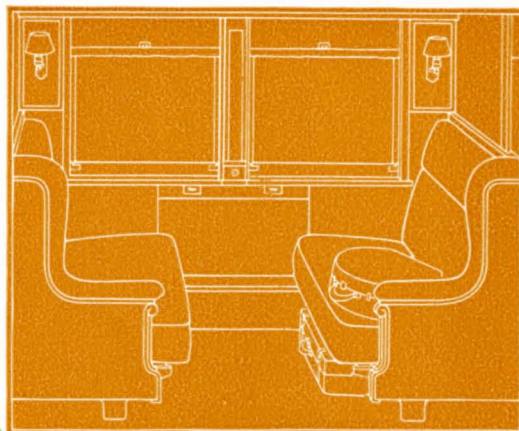

THE SECTION—(at left: view from aisle)—DIMENSIONS: Length 6 feet, 2 inches; width 35 inches. Mattress, spring type. Luggage space under seat: height 9 inches, depth $16\frac{1}{2}$ inches, length $28\frac{1}{2}$ inches. Window opening: width $24\frac{7}{8}$ inches, height $16\frac{3}{4}$ inches.

The Bedroom

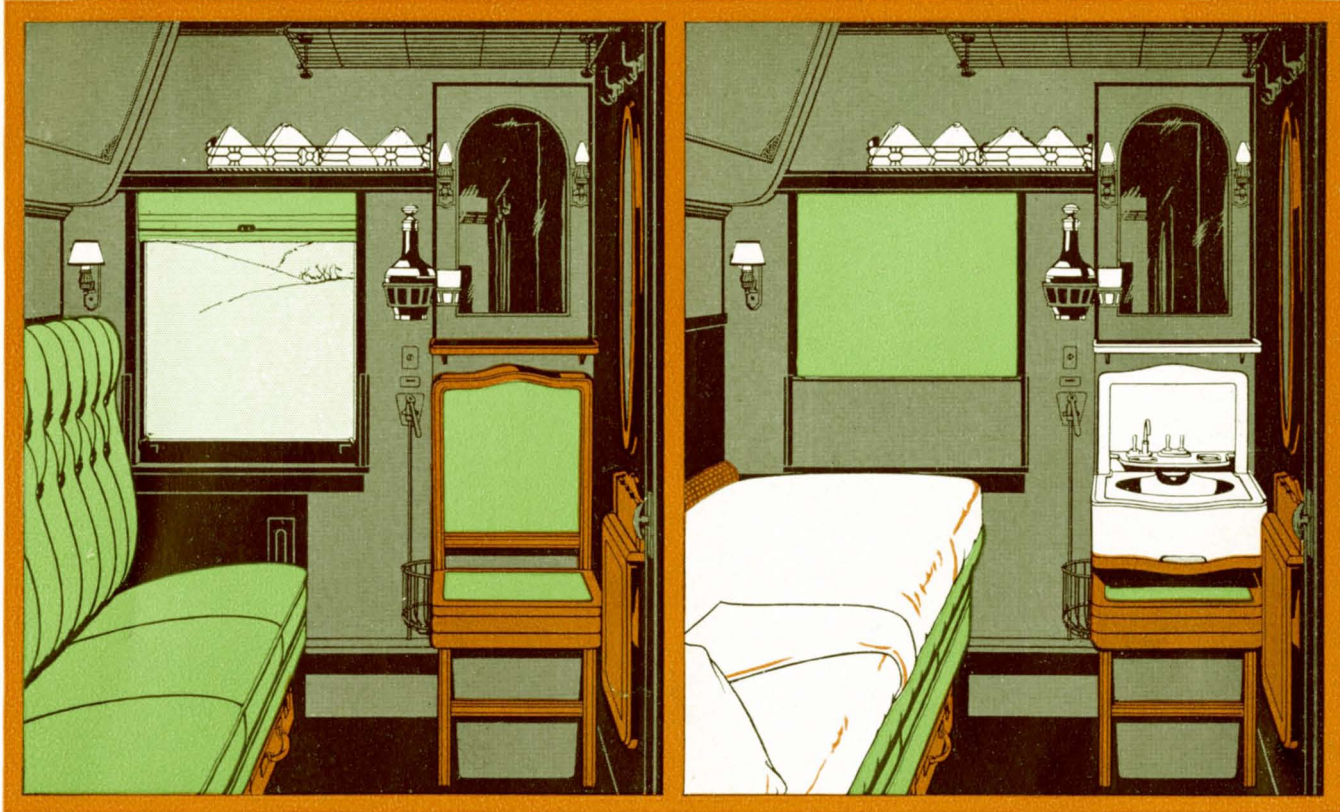

A bedroom is an enclosed private room, and contains a wide, comfortable sofa. For night time use this sofa with a spring mattress forms a comfortable bed. Each of the two pillows has $2\frac{1}{2}$ pounds of goose-feathers. Above the sofa, in most bedrooms, is an upper berth which similarly makes down into a bed. The bedroom has private toilet and a wash basin which folds back to form an extra seat. A folding desk provides a writing table as well as a service table for meals. The room is provided with electric lights, separate

heat control, an adjustable ventilator in the door, and blow and exhaust fans—all of which allow occupant to regulate room temperature to suit his desire. A vacuum water bottle for ice water is included as well as clothes hooks and a full length mirror. At night the bed of a single bedroom accommodates one adult and one small child. In a double bedroom, two adults and two small children could be similarly accommodated. The cost of occupying a bedroom is small indeed in relation to the comfort and convenience provided.

THE BEDROOM—TARIFF: Railroad transportation required: for one adult—one rail fare. Charges for one person, the sum of the upper and the lower berth rates; for two, twice the lower berth rate.

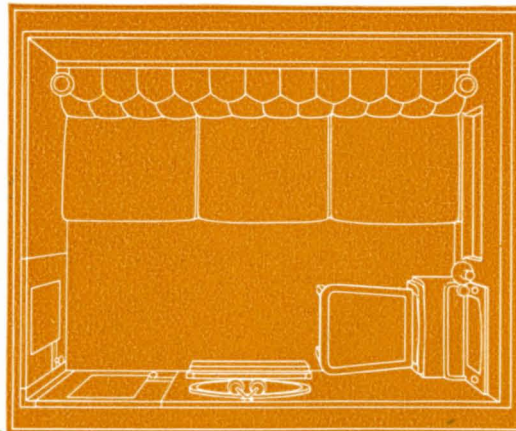

THE BEDROOM—(At left: floor plan)
DIMENSIONS: Total floor area, $33\frac{7}{10}$ square feet. Mattresses, spring type. Luggage space under sofa: height, 9 inches, depth $16\frac{1}{2}$ inches, length 42 inches. Window opening: width $24\frac{7}{8}$ inches, height $16\frac{3}{4}$ inches.

The Compartment

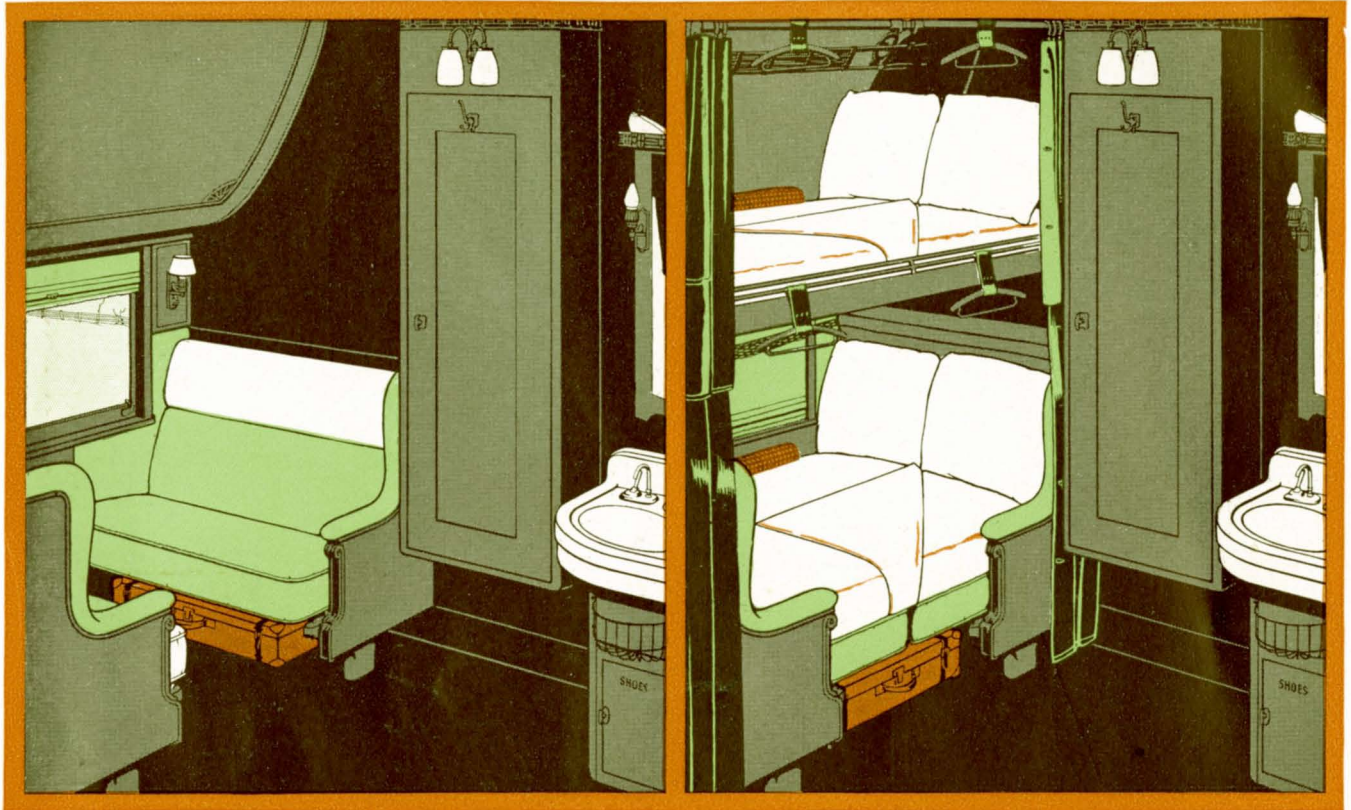

A compartment affords complete privacy for one or more occupants and contains electric lights and fan, separate heat control, shelf for luggage, hammock for clothes, a coat, skirt and suit hanger, and electric bell with which to summon porter at any hour. It has upper and lower berths and private toilet and lavatory. Many compartments also contain wardrobes, where, particularly on long journeys, clothing may be hung at full length. Mattresses are of spring construction and are $4\frac{1}{2}$ inches thick. Each pillow contains $21\frac{1}{2}$ pounds of finest goose-feathers. In many cars

containing both a compartment and drawing room, the two rooms can be used en suite by opening the connecting door. Meals may be served in your compartment. For daytime travel there is ample room to seat four passengers comfortably. At night one or two adults are accommodated comfortably in either berth, upper or lower. The porter will install a sturdy table between the seats for dining, writing, or games, if desired. The compartment is a de luxe type of accommodation which goes far to make traveling by rail comfortable and enjoyable.

THE COMPARTMENT—TARIFF: Railroad transportation required: for an adult—generally one and one-half rail fares. In Canada and certain parts of U. S. only one rail ticket is required. Pullman rate—approximately same as charged for two lower berths and an upper berth.

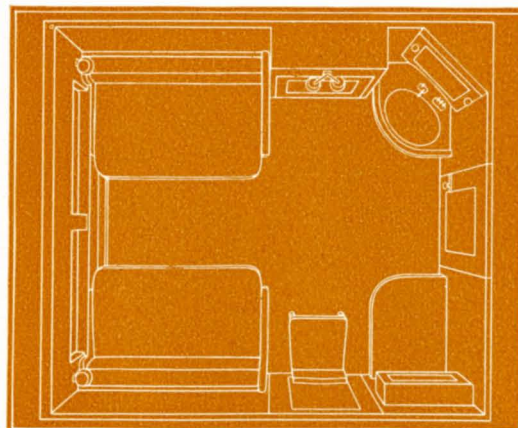

THE COMPARTMENT—(At left: floor plan) **DIMENSIONS:** Total floor area, $41\frac{1}{2}$ square feet. Length of beds, 6 feet, 2 inches, width 35 inches. Mattresses, spring type. Luggage space under seat: height 9 inches, depth $16\frac{1}{2}$ inches, length $28\frac{1}{2}$ inches. Window opening: width $24\frac{7}{8}$ inches, height $16\frac{3}{4}$ inches.

The Drawing Room

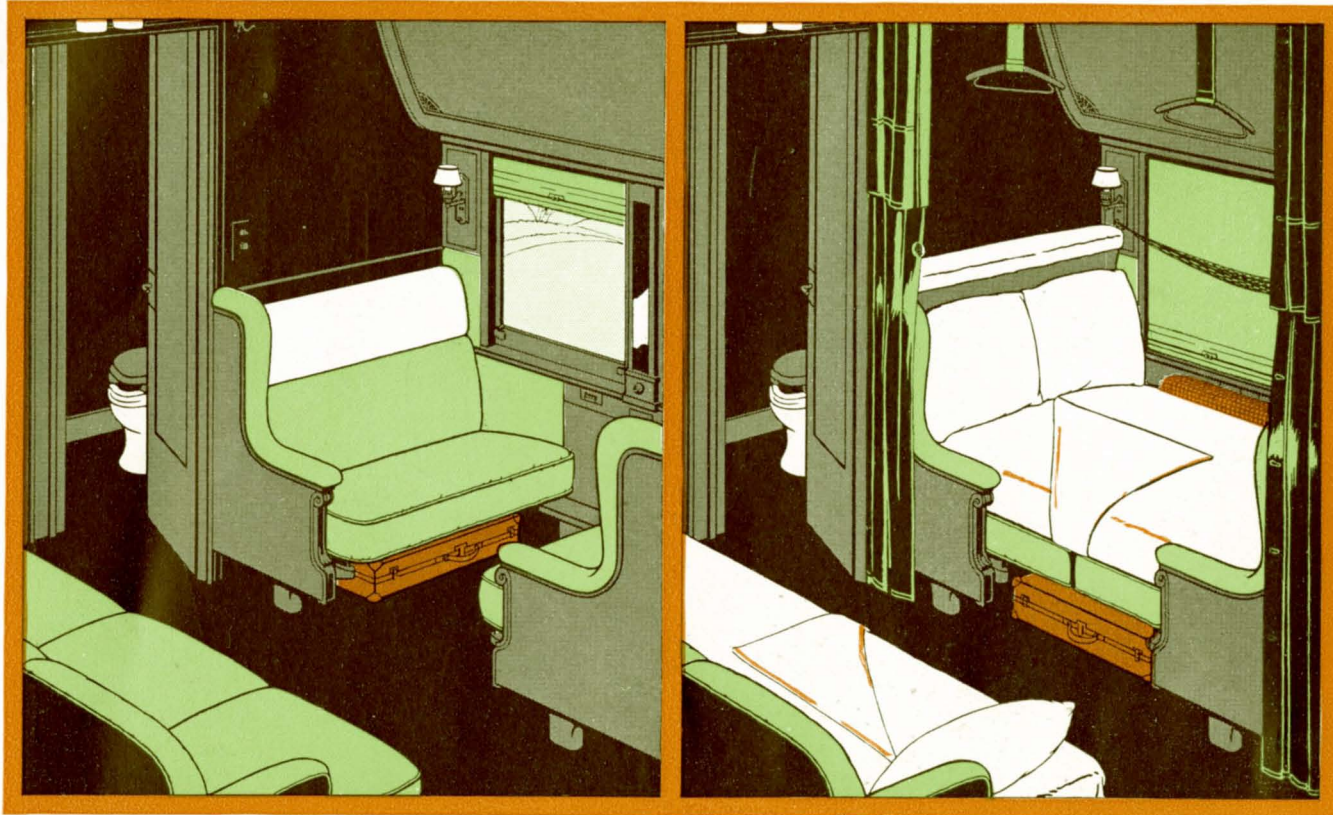

The drawing room in a Pullman car is the last word in travel luxury, providing complete seclusion. For family use it is particularly advantageous since it contains 58 square feet of floor area, including a separate room containing toilet and lavatory. In addition to upper and lower berths there is a sofa 6 feet, 2 inches in length and 25 inches in width, useful for daytime rest and which may be transformed into a comfortable bed at night. Excellent spring-base mattresses each contain $6\frac{1}{2}$ pounds of resilient horsehair. The drawing room is equipped with six pillows, two for each

berth and the sofa. Each contains $2\frac{1}{2}$ pounds of downy goose-feathers. For meals, or for writing or games, the porter will install a sturdy table. A drawing room is furnished with electric lights and fan, separate heat control, space for luggage, hangers for clothes, and an electric bell with which to summon the porter at any hour. For daytime travel there is ample room to seat four or more passengers comfortably. At night the commodious upper and lower berths accommodate one or two adults and the sofa one adult. Relaxation by day, deep sleep at night are assured all Pullman travelers.

THE DRAWING ROOM—TARIFF: Railroad transportation required: In United States, two rail fares, minimum. In Canada, one rail fare. Pullman charge — approximately three and a half times lower berth rate.

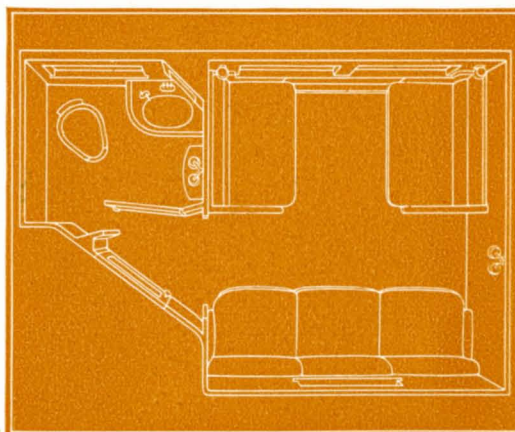

THE DRAWING ROOM — (at left: floor plan)—DIMENSIONS: Total floor area, 58 square feet. Sofa: 6 feet 2 inches long, 25 inches wide. Mattresses, spring type. Luggage space under seats: height 9 inches, depth $16\frac{1}{2}$ inches, length $28\frac{1}{2}$ inches. Window opening: width $24\frac{7}{8}$ inches, height $16\frac{3}{4}$ inches.

The Parlor Car



For those travelers whose journey occupies chiefly the daylight hours Pullman provides the parlor car. It is a long, airy, spacious, well-lighted car with individual upholstered chairs from which the occupant may face the view of the passing countryside through wide, clear windows, or turn his chair inward for reading and restful relaxation. Porter will install sturdy table for writing or games, if desired. Provision is made for proper ventilation and air circulation. Ample facilities are provided for light luggage and wraps.

Electric lights are placed advantageously throughout the car so that, if darkness comes, each passenger is supplied with adequate light for reading. The parlor car is to the daytime traveler what the Pullman sleeping car is to the overnight patron. It is here that travel departs from the ordinary business of getting from one place to another and becomes a time of rest and relaxation. The details of comfort embodied in the Pullman parlor car are many, but unobtrusive, as Pullman believes comfort should be *felt*, rather than seen.

PARLOR CAR SEAT—TARIFF: *Railroad transportation required: for an adult—one rail ticket; for a child (5 to 12 inclusive)—half fare. Pullman rate is about 1/2¢ a mile, minimum charge 50c.*

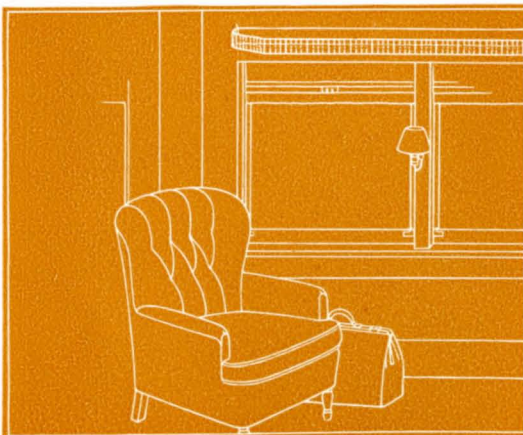

THE PARLOR CAR SEAT (illustrated at left) is deep and roomy, patterned after the best of club type furniture. Plenty of room between seats. Depending on type of car, the number of chairs range from 28 to 40. Chairs assigned to individual passengers by number. Wall brackets and stand lamps.

The Parlor Car Drawing Room

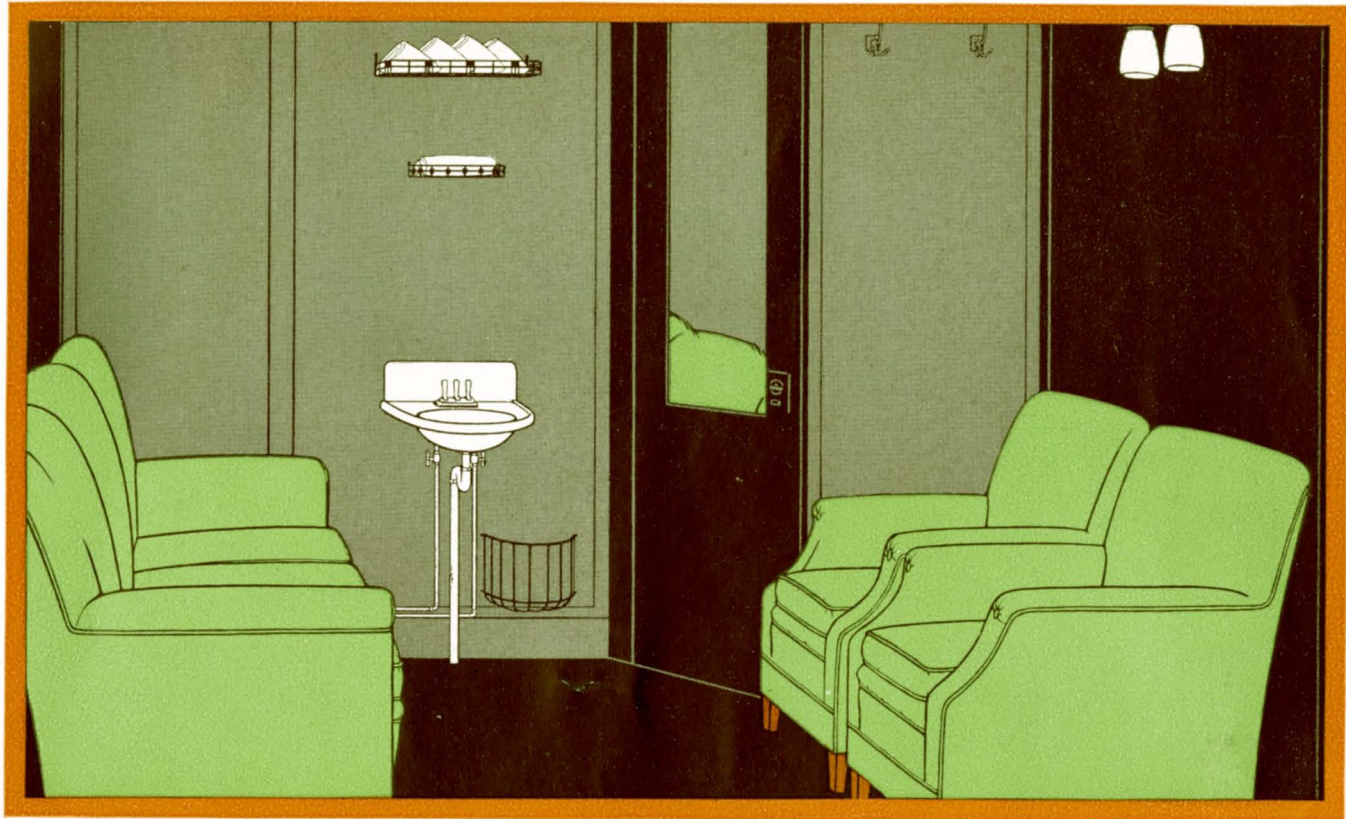

For the greater privacy of groups traveling on daylight runs there is the parlor car drawing room, accommodating up to five persons. There is a generously proportioned sofa for three, and two over-stuffed chairs. The room contains a lavatory and accessories, mirror and coat hangers. It is illuminated by wall-brackets conveniently spaced. The porter will install a large, sturdy table for meals, writing or games, if desired. The parlor car drawing room is particularly comfortable for invalids or those who desire to recline while trav-

eling. It is also frequently the rendezvous of business men traveling to conferences, and of college students at vacation time. Long ago Pullman found that privacy was a thing very much desired by many travelers. There are people who cannot relax and be comfortable when among strangers. The privacy of many Pullman accommodations overcomes this constraint and invites the traveler to be himself, to enjoy his trip, to feel that a gracious and considerate host stands between him and those he may not care to see.

THE PARLOR CAR DRAWING ROOM—
TARIFF: *Railroad transportation required. In United States, two rail fares minimum. Pullman charge — approximately five seat fares.*

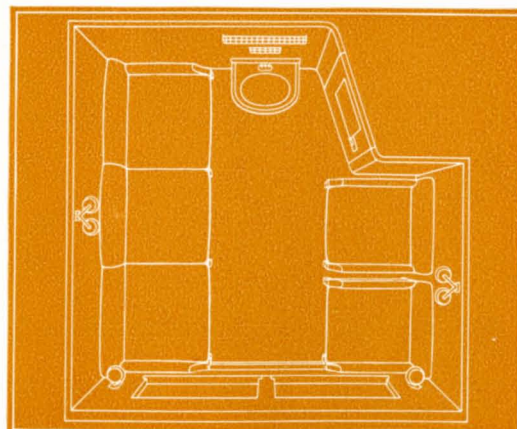

THE PARLOR CAR DRAWING ROOM.
 (at left: floor plan) **DIMENSIONS:**
 7 feet by 6 feet, 8 inches. Floor area
 42½ square feet. Sofa, 5 feet, 8¾
 inches by 21¼ inches. Window
 opening: 24⅞ by 16¾ inches.

Floor Plan of 12 Section - Drawing Room Pullman Sleeping Car

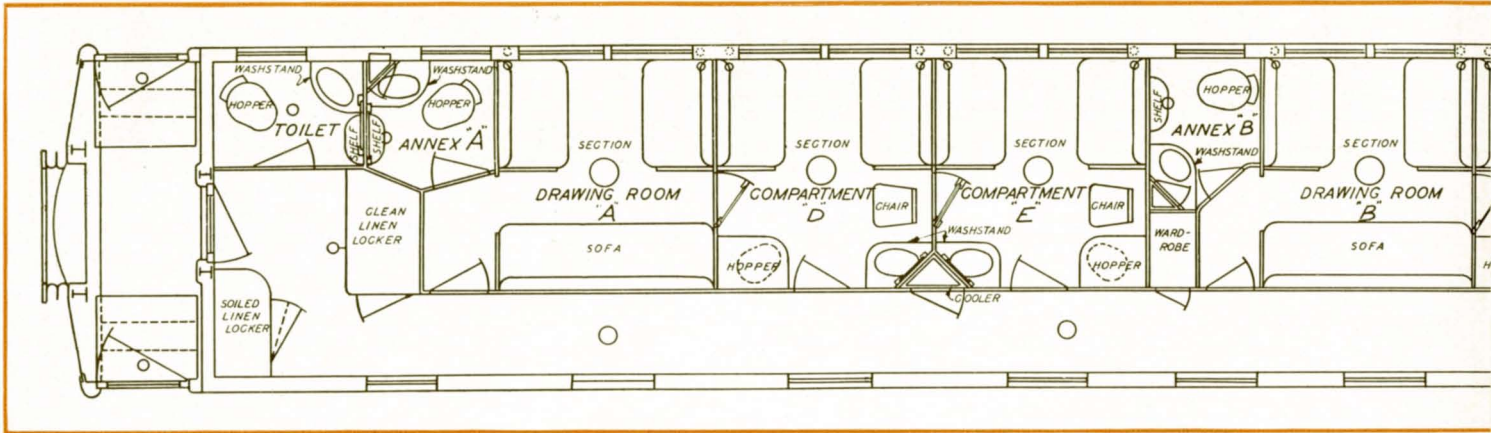
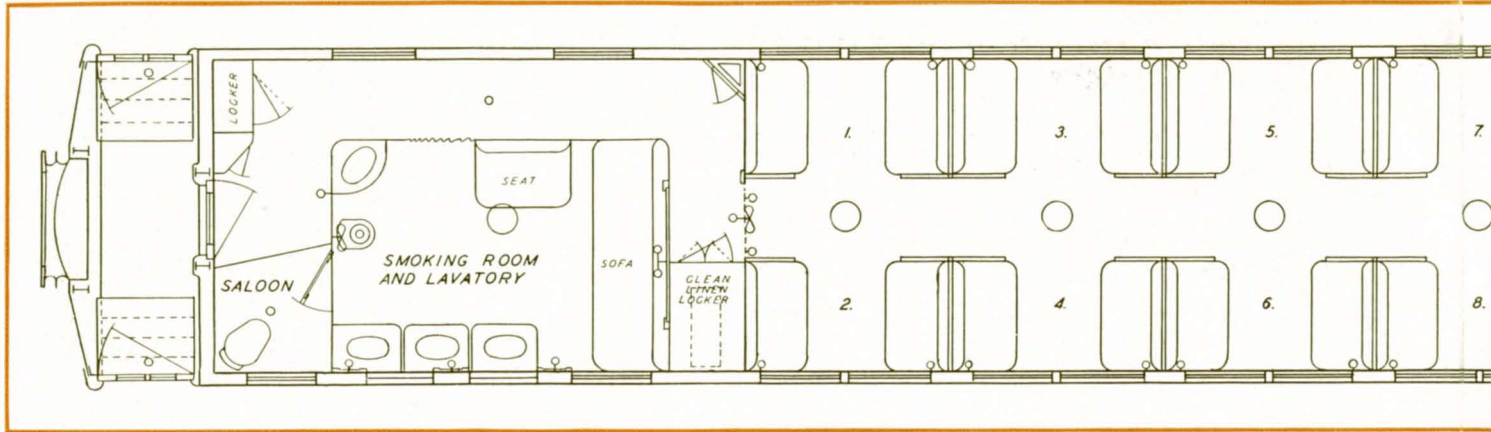

Floor Plan of Pullman Parlor Car

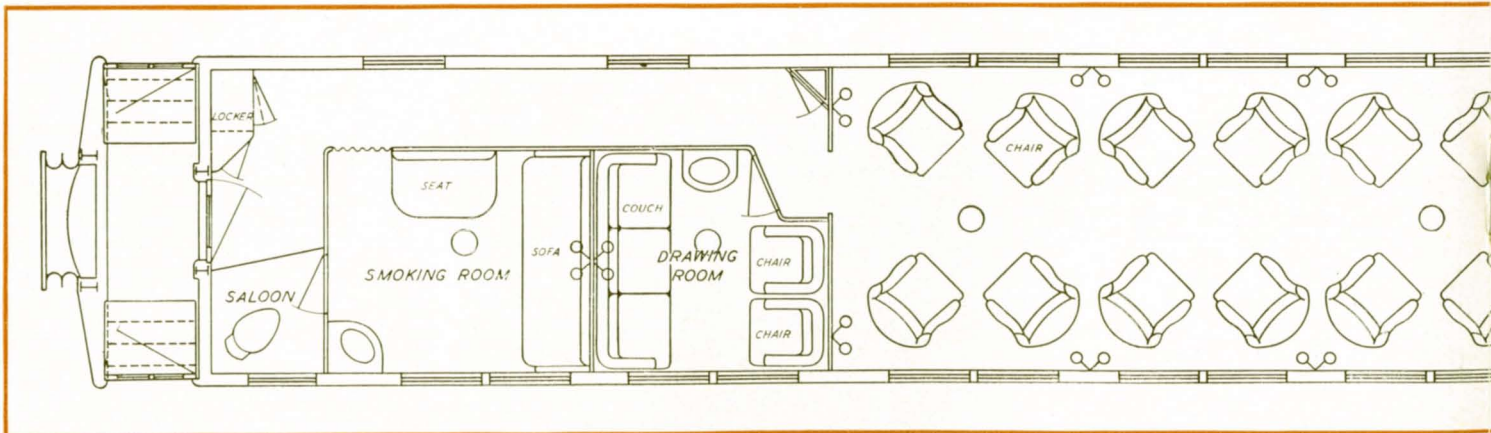

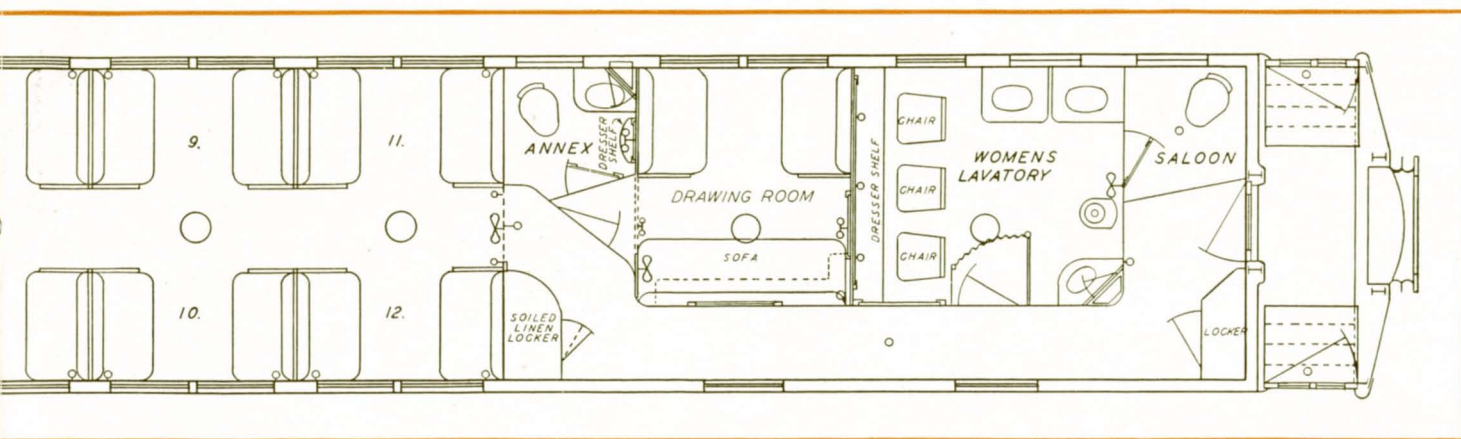

Floor Plan of Drawing Room-Compartment Pullman Sleeping Car

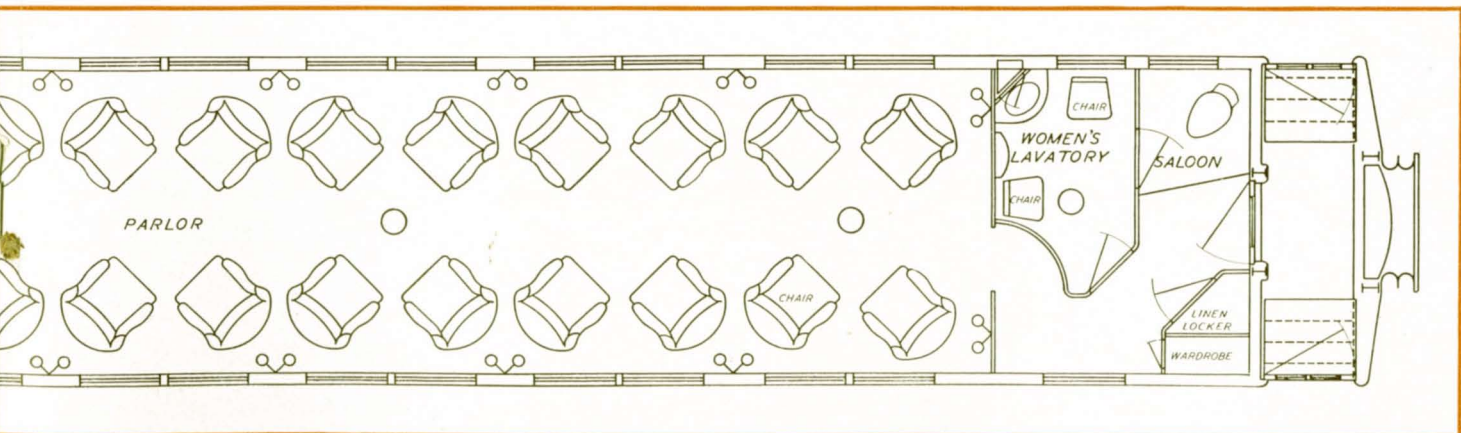
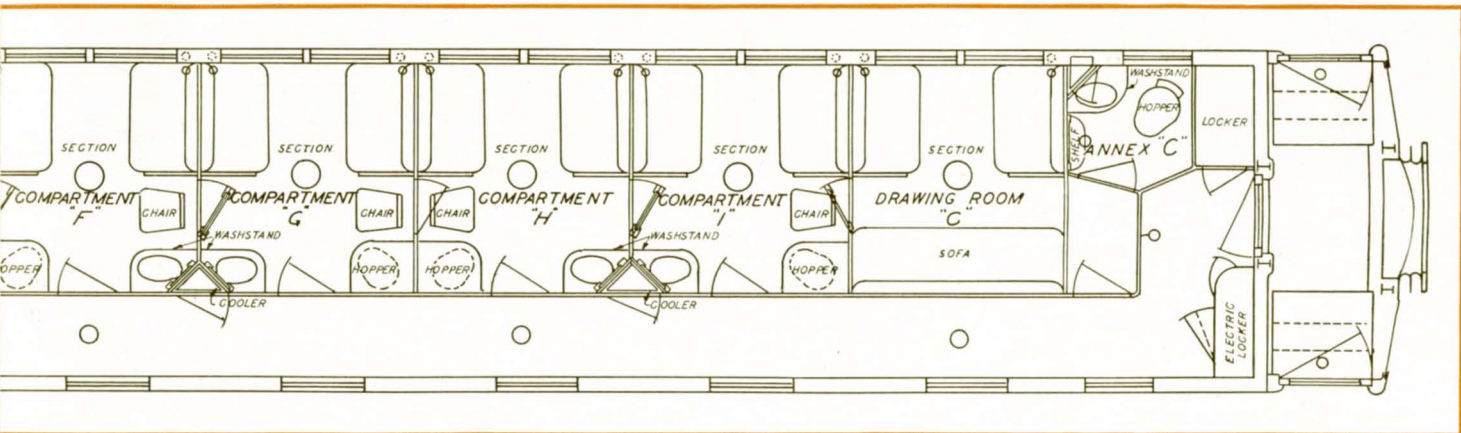

+ + + *And in addition*

AT NO EXTRA COST TO YOU

Pullman provides a splendidly equipped boudoir-dressing room for feminine travelers, a well-appointed dressing room for masculine needs, and many trains carry lounge and observation cars where all may have freedom to move about and to relax in generously proportioned club type chairs and sofas. All these are available to the Pullman traveler without additional cost; all a part of Pullman service and hospitality.

The Lounge Car

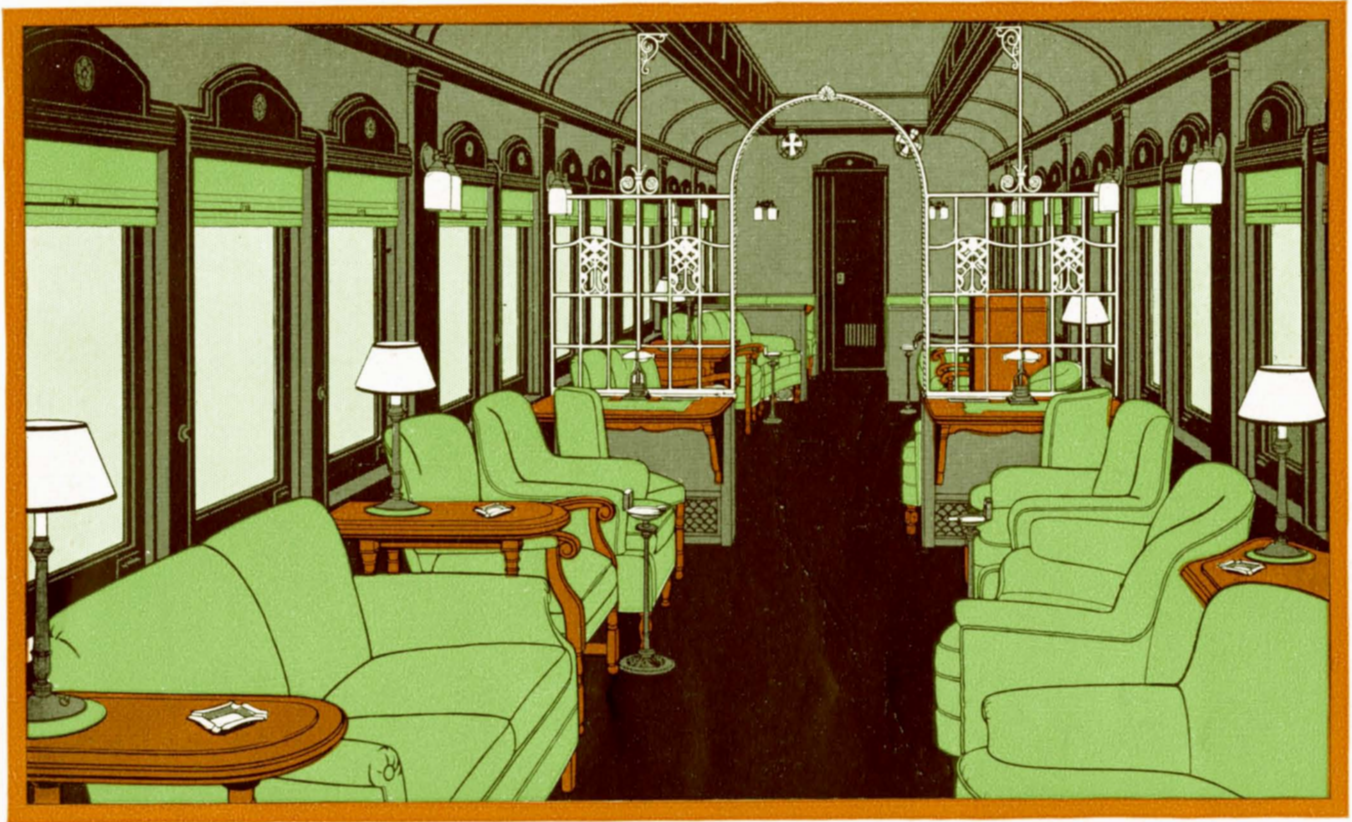

This car is a characteristic Pullman contribution to the ease of travel, carrying forward principles formulated 75 years ago when Pullman set out to add to rail travel a degree of comfort then unknown. The lounge car allows the passenger freedom of movement, and provides a variety of comfortable chairs and sofas in which he may lounge and enjoy the scenery. In most instances buffet service is available in a portion of the car. Writing facilities, with convenient desk-lamp lighting, add to its attractiveness. Smoking stands and magazine tables are additional conveniences. The lounge car is ideal for complete relaxation, and creates an inviting atmosphere of sociability in travel. Like a hospitable living room, it is furnished in discriminating and excellent taste. Chairs and sofas are those you would expect to find in good homes and clubs. Tables and lighting fixtures likewise are in the decorative mode. Deep soft carpeting covers the floor in pleasing colorful harmony with the decorative scheme. Comfort reaches an appreciable new level in this distinctive Pullman accommodation.

The Observation Car



The observation car has been likened to the solarium of a well-appointed home. This car is equipped with wide, clear windows and an open observation platform or sun room at the rear where the passenger may view the scenery. This car is well lighted, and provides an easy, informal atmosphere for Pullman travelers. Writing facilities are provided, together with magazines, smoking stands and table lamps, all designed to make traveling a more enjoyable experience. Examining precedent with a critical eye, rejecting what was merely the best idea at the time, retaining proved engineering principles, Pullman created the new type observation car to synchronize with the times. It is distinctly a new experience to occasional travelers to walk into a modern Pullman observation car for the first time. The initial impression is one of intense daylight, due to the generous size of the windows. Coupled with luxurious furnishings and their quiet taste, this flood of light reminds one of a bright, airy solarium or sun-deck; a place for play, for rest, for pleasurable hours.

The Restaurant Car

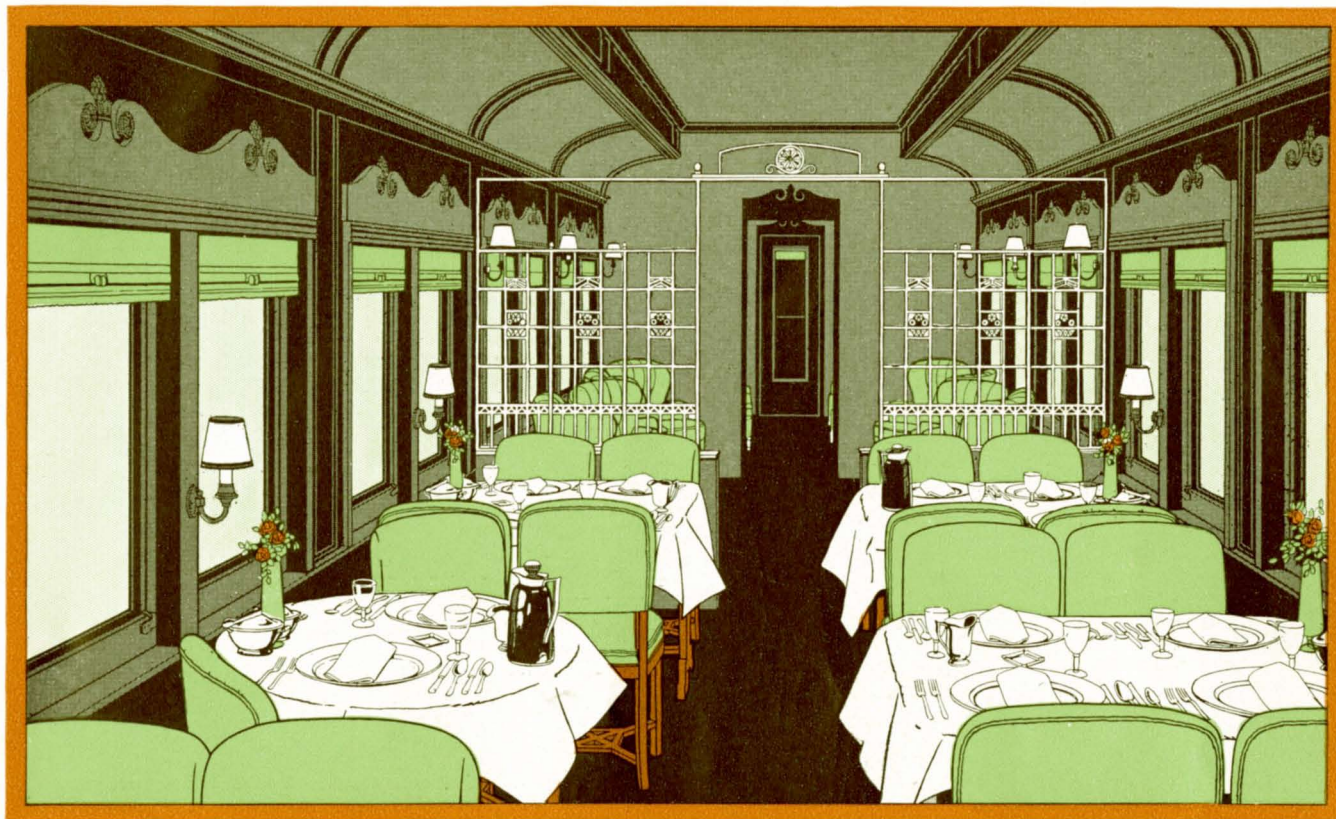

The restaurant car is an innovation in Pullman travel. The restaurant occupies a portion of a lounge, parlor or sleeping car and offers complete dining service, as well as soft and mixed drinks. This car is generally used on runs where the customary dining car is not operated. Attendants are continuously at the service of passengers who wish to dine. The restaurant car injects a new home-like informality into rail travel, and the service is available to coach, as well as Pullman passengers. The intimate air of the restaurant car suggests the nature of its cuisine. While it is possible to obtain a substantial dinner, the usual passenger is content with choice viands, notable more for their excellent individual preparation and reasonable cost than for their part in a large meal. The chef in charge is one whose experience and abilities are distinct and apparent in the food he prepares. It is his pleasure to serve you capably and well. There is no formality about the Restaurant Car. You come and go when you please, just as you eat what pleases your taste. Pullman hospitality is nowhere more evident.

The Women's Dressing Room

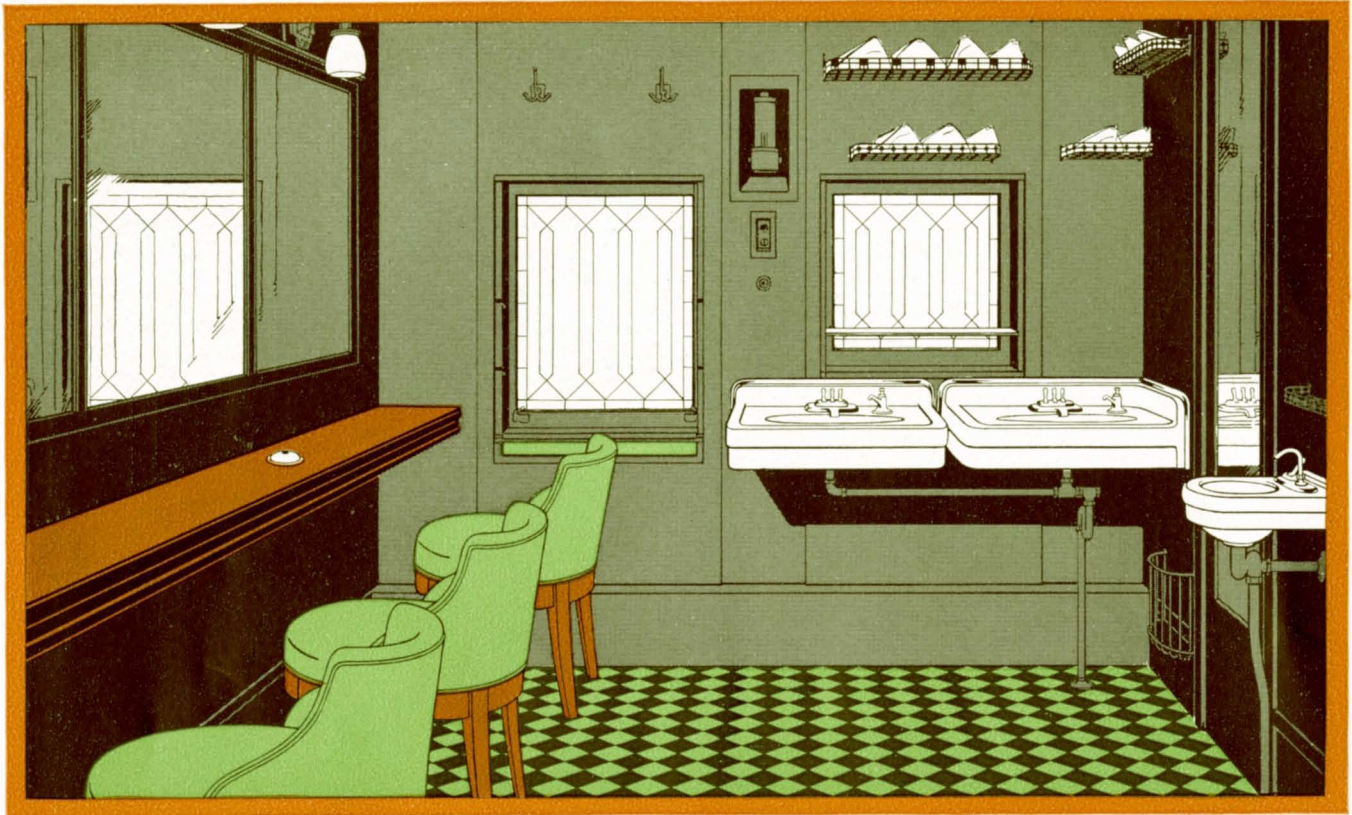

This room is luxuriously equipped for the comfort of women who travel and provides a space approximately 50 square feet in area, with a dressing table and mirrors. The mirrors total 18 square feet in area and occupy one side of the room above the dressing table. Three dressing table chairs of convenient height are placed in front of the mirrors. There are two to three wash basins, a dental lavatory, and a separate toilet compartment. There are racks for bags and hooks for clothes, with a generous supply of towels, soap

dispensers, and other modern lavatory arrangements. A water cooler with drinking cups is provided. The room is lighted by a chandelier and four bracket lamps. Exhaust ventilator and fan complete the conveniences of this room planned for the accommodation of feminine travelers. The women's dressing room is symbolic of what has taken place in transportation since the first Pullman car was built. Every nicety of gracious and comfortable living is considered in the design and equipment of Pullman accommodations.

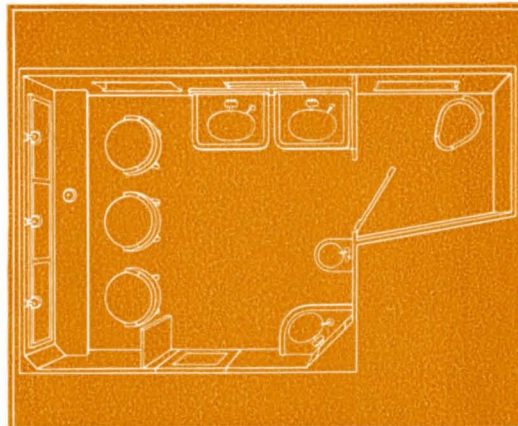

WOMEN'S DRESSING ROOM. *This floor plan (at left) shows the convenient arrangement of chairs, mirrors, and washbowls, allowing women travelers generous room in which to make their toilets. Observe that the toilet is located in a separate room.*

The Men's Dressing Room

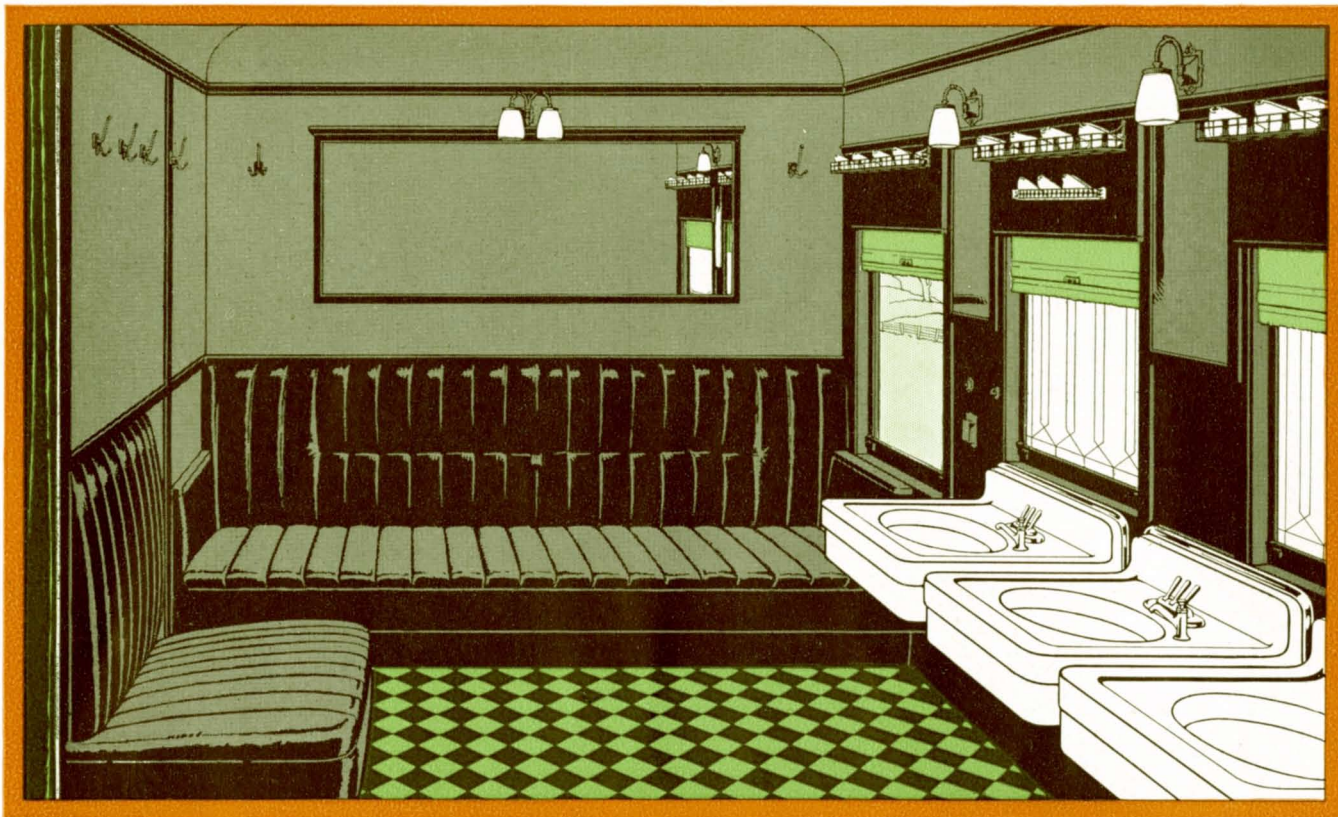

This room has an area of 64 square feet, and is equipped to provide all the conveniences necessary to the masculine toilet. There are three wash bowls and one dental lavatory, with large mirrors so placed and lighted as to make shaving comfortable and easy. Automatic soap dispensers and other sanitary appliances, including a generous supply of towels, are provided. There are convenient slot containers for the disposal of old razor blades. A leather sofa and a smaller settee provide a place for the toilet kits or suitcases

which travelers employ. The toilet is in a private connected compartment. During the day the room provides a comfortable lounge for the smoker, a social gathering place, often described as the traveling men's forum. While men are not supposed to demand elaborate equipment or embellishment in quarters dedicated to their comfort and convenience, there is in the men's dressing room that extra margin of luxury which calls forth silent appreciation from every traveler, helping him, as it were, to "start the day right."

MEN'S DRESSING ROOM. This floor plan (at right) indicates the combination of toilet facilities with comfortable sofas, allowing gentlemen travelers generous room in which to complete their toilets. Observe the location of toilet in separate room.

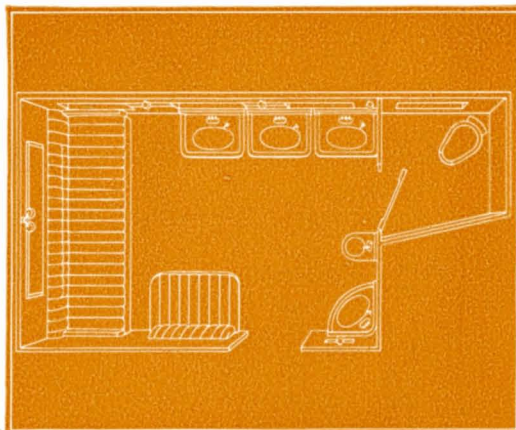

For 75 Years

PULLMAN HAS CULTIVATED THE ART OF MAKING
PEOPLE COMFORTABLE WHILE TRAVELING



EVERY Pullman conductor and Pullman crew is rigorously trained in the technique and the art of Pullman hospitality. They welcome opportunities to help you secure comfort and relaxation on your travels. With the wide range of Pullman accommodations generally found on Pullman-equipped trains you are free to move about as you would in your own home—a stroll to the lounge, a snack in the restaurant car, or forty undisturbed winks in your own “reservation.”



FOR ADDED PRIVACY AND CONVENIENCES



If you desire the greater privacy and added conveniences of bedroom, compartment or drawing room, your Pullman conductor will gladly transfer you, at the small additional cost explained on previous pages.



Air-Conditioning

A NEW PULLMAN SERVICE

AIR-CONDITIONING, the latest development in Pullman travel service, is being progressively installed in all Pullman cars. Eventually every Pullman traveler will find himself surrounded with controlled atmosphere—akin to that of a fine Spring day—tempered and conditioned for the greatest bodily comfort. Nearly thirty years ago Pullman engineers started “conditioning” the air in Pullman cars by exhausting air out of the car, allowing fresh air to enter through cracks and crevices. Later an easier and more continuous flow of air was accomplished by more scientific fan arrangement. Pullman engineers have now conquered the heat and excessive humidity of summer, the dirt and dust of dry weather, the stuffiness and dryness of the closed, steam-heated room in winter.

There is no need to open windows for fresh air in an air-conditioned Pullman. A generous supply of outside air is continuously drawn in by suction fan, filtered and cleansed of dirt, dust, pollen, and other impurities. This fresh, clean air is blown over cooling or heating coils, as the season dictates. A system of air ducts gently circulates the conditioned air to every part of the car.

Drawing rooms, compartments and bedrooms are provided with individual heat control. In air-conditioned cars they are also equipped with cooling control shutters. These two types of control enable the occupant to temper the atmosphere of his room to suit his own preference, assuring him complete comfort in any season of the year.

In summer no attempt is made to maintain a *constant* temperature in an air-conditioned Pullman car. There is no single temperature which gives the highest degree of comfort to everyone. Rather there is a *range of balanced temperature and humidity* in which comfort is more nearly universal. The range of temperature desired in summer is always a little higher than that desired in winter, as a temperature agreeable in winter would give a distinct sensation of coolness on a very hot day. Accordingly, the balance of comfort factors in an air-conditioned Pullman, carefully determined by scientific study, shifts back and forth as seasons change, according a maximum degree of comfort to every traveler.

Experiments prove the beneficial effect of air-conditioned rooms on persons suffering from hay fever, pollen-asthma and similar respiratory trouble. In many cases, persons afflicted with these troubles who have traveled in air-conditioned Pullmans, have reported distinct relief. The filters which remove pollen and other dust contribute largely to this relief.

The air-conditioning system installed in Pullman cars functions throughout the year, and although its effects are most noticeable in very hot weather, it is equally beneficial in winter when the cooling system is not required. Fresh, clean air, gently circulated, is the all-season benefit to Pullman travelers, who enjoy also the sensation of being comfortably cool in summer, comfortably warm in winter.



THE PULLMAN COMPANY
CHICAGO, U. S. A.

Pullman

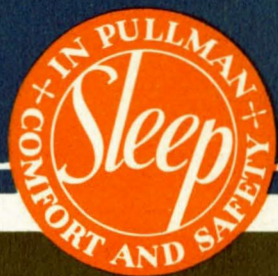

Accommodations