

Fastest Streamliner From  
Chicago to Seattle

When Great Dome coaches went into service on the Empire Builder the Great Northern also inaugurated the fastest running time of any streamliner between Chicago and Pacific Northwest cities via St. Paul and Minneapolis. The Empire Builder's westbound schedule was shortened 1 hour—from 45 to 44 hours to Seattle and 43½ hours to Portland.

The faster running schedule permits a later leaving time from Chicago—now 2 P.M. (CST) daily from Chicago's Union Station—and provides more convenient connections with the Empire Builder for passengers from Eastern and Southern cities. Although 1 hour faster westbound, the Empire Builder arrival times in Spokane, Seattle and Portland have not been changed. There has been no change in the running time of the eastbound streamliner from the Pacific Coast to Chicago.

Complete information on Summer vacation tours on the Empire Builder and other Great Northern trains is available on request to:

P. G. HOLMES  
Passenger Traffic Manager  
Great Northern Railway Co.  
St. Paul 1, Minnesota

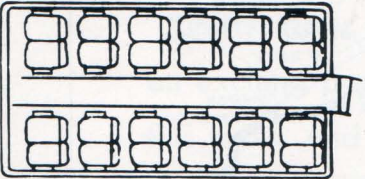

Seating arrangement in upper level of each dome coach.

Seating arrangement on the lower level of each dome coach.

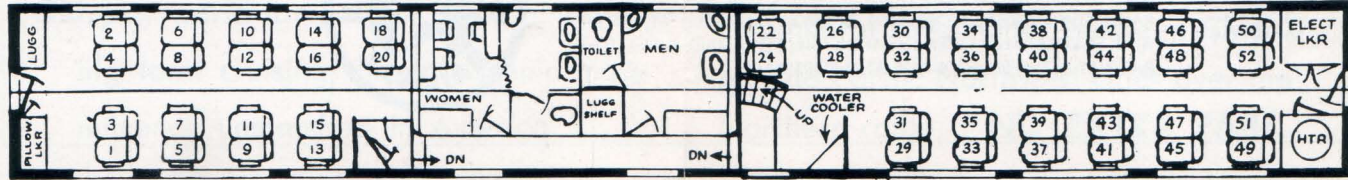

EFFECTIVE MAY 29, 1955

THE EMPIRE BUILDER

Condensed schedules including connections, of Great Northern Railway Trains No. 1 (westbound) and No. 2 (eastbound) between Chicago, St. Paul, Minneapolis, Spokane, Seattle and Portland.

Westbound—Read Down			Eastbound—Read Up		
Empire Builder Daily	Miles	Central Standard Time	Miles	Empire Builder Daily	
<b>Burlington Route</b>					
2 00PM	0	Lv Chicago, Ill.	Ar	427	2 00PM
2 36	38	" Aurora, Ill.	"	389	2 18
4 16	145	" Savanna, Ill.	"	282	11 30AM
4 56	184	" East Dubuque, Ill.	"	243	10 50
5 40	239	" Prairie du Chien, Wis.	"	188	
6 23	297	" La Crosse, Wis.	"	130	9 19
6 57	327	" Winona Jct., Wis.	"	100	8 45
8 40	427	Ar St. Paul, Minn.	Lv	0	7 15
<b>Great Northern Railway</b>					
9 10PM	0	Lv St. Paul, Minn.	Ar	1783	7 00
9 35	11	Lv Minneapolis, Minn.	Lv	1772	6 30
9 40	11	Lv Minneapolis, Minn.	Ar	1772	6 25
11 10	102	Ar Willmar, Minn.	Lv	1681	4 40
11 12	102	Lv Willmar, Minn.	Ar	1681	4 37
12 12AM	215	Ar Breckenridge, Minn.	Lv	1568	2 42
12 55	215	Lv Breckenridge, Minn.	Ar	1568	2 37
1 45	262	Ar Fargo, N.D.	Lv	1521	1 30
1 50	262	Lv Fargo, N.D.	Ar	1521	1 25
3 47	386	Ar New Rockford, N.D.	Lv	1397	11 29PM
3 49	386	Lv New Rockford, N.D.	Ar	1397	11 27
5 26	495	Ar Minot, N.D.	Lv	1288	9 50
5 35	495	Lv Minot, N.D.	Ar	1288	9 42
7 55	615	Ar Williston, N.D.	Lv	1168	7 20
<b>Mountain Standard Time</b>					
7 05AM	615	Lv Williston, N.D.	Ar	1168	6 10
7 45	771	" Glasgow, Mont.	Lv	1012	5 30
12 25PM	924	Ar Havre, Mont.	Lv	859	12 20
12 35	924	Lv Havre, Mont.	Ar	859	12 10PM
1 40	986	" Chester, Mont.	"	797	11 03AM
2 30	1028	" Shelby, Mont.	"	755	10 15
3 03	1053	" Cut Bank, Mont.	"	730	9 45
6 10	1179	Ar Whitefish, Mont.	Lv	604	6 40
6 15PM	1179	Lv Whitefish, Mont.	Ar	604	6 35AM
9 05	1314	Ar Troy, Mont.	Lv	469	3 40
<b>Pacific Standard Time</b>					
8 05	1314	Lv Troy, Mont.	Ar	469	2 40
11 30	1453	Ar Spokane, Wash.	Lv	330	11 15PM
11 35PM	1453	Lv Spokane, Wash.	Ar	330	10 45PM
1 44AM	1575	" Ephrata, Wash.	Lv	208	8 25
3 20	1627	Ar Wenatchee, Wash.	Lv	156	7 20
3 35	1627	Lv Wenatchee, Wash.	Ar	156	7 10
5 46	1698	" Skykomish, Wash.	"	85	5 07
7 02	1750	" Everett, Wash.	"	33	3 51
8 00	1783	Ar Seattle, Wash.	Lv	0	3 00
<b>SERVICE TO AND FROM PORTLAND</b>					
<b>Spokane, Portland &amp; Seattle Railway</b>					
12 06AM	1453	Lv Spokane, Wash.	Ar	380	10 35PM
7 05	1823	Ar Vancouver, Wash.	Lv	10	3 23
7 30	1833	Ar Portland, Ore.	Lv	0	3 00
<b>Connections to and from Vancouver, B. C.</b>					
8 10AM	2 00PM	Lv Seattle, Wash.	Ar	12 15PM	4 25PM
9 01	2 50	" Everett, Wash.	Lv	11 25AM	3 30
10 19	4 10	Ar Bellingham, Wash.	Lv	10 02AM	2 45
11 55	5 40	Ar Vancouver, B. C.	Lv	8 25	12 30
<b>Connections to and from Tacoma, Portland and California</b>					
8 20AM	12 30PM	Lv Seattle, Wash.	Ar	1 40PM	5 45AM
9 12	1 22	Ar Tacoma, Wash.	Lv	12 45	4 30
10 22	2 32	" Centralia, Wash.	"	11 33AM	2 45
11 14	3 24	" Kelso-Longview, Wash.	"	10 38	1 15
12 20PM	4 30	Ar Portland, Ore.	Lv	9 40	11 45PM
<b>Southern Pacific Lines</b>					
Shasta Daylight	Cascade	Lv Portland, Ore.	Ar	9 20AM	11 30PM
7 45AM	4 45PM	Ar Oakland Pier, Calif.	Lv	5 33PM	8 15AM
10 55PM	8 35AM	" San Francisco, Calif.	"	6 00	7 45
11 30	9 15	Ar Los Angeles, Calif.	Lv	6 55AM	6 00PM
10 30AM	7 05PM				
<b>Connections to and from Great Falls via Daily Bus</b>					
12 45PM	0	Lv Havre, Mont.	Ar	123	11 59AM
3 30	123	Ar Great Falls, Mont.	Lv	0	9 15
<b>Connections to and from Kalispell via Daily Bus</b>					
6 05PM	0	Lv Whitefish, Mont.	Ar	13	6 20AM
6 35	13	Ar Kalispell, Mont.	Lv	0	5 50
<b>Connections from and to Duluth—Superior</b>					
<b>Great Northern Railway</b>					
Gopher Daily	Ar Duluth.	Ar			
4 30PM	" Superior.	Lv			
4 45	Ar Minneapolis.	Lv			
7 15					
<b>Badger Daily</b>					
	Lv Duluth.	Ar			
	" Superior.	Lv			
	Ar Minneapolis.	Lv			

(1) Conditional stop. Information concerning conditional stops can be obtained from Train Conductor. (2) Passengers for eastbound Empire Builder change at Everett. Schedules subject to change without notice. Complete Great Northern Railway time table folder obtainable from Porter.

Printed in U.S.A.

GREAT DOMES

ON GREAT NORTHERN'S  
EMPIRE BUILDER



BETWEEN CHICAGO • ST. PAUL • MINNEAPOLIS  
SPOKANE • SEATTLE • PORTLAND





Sightseeing through big picture windows.

## GREAT DOMES ON THE EMPIRE BUILDER

With new **Great Dome** cars now an exciting part of the Empire Builder, this sleek and swift streamliner more than ever is the West's most colorful train, world-famous for smooth, relaxing land cruising through scenic magnificence unmatched in America.

When 20 Great Domes have gone into service by early Fall, each of the five trains in the Empire Builder fleet will offer 147 "penthouse" seats for passengers, more than any other trans-continental streamliner between Chicago and Pacific Northwest cities over the Northern route. **NO EXTRA FARE.**

An impressive feature of the Great Domes is the dramatic use of color and art in the interiors.

Developed by Philip Will Jr., nationally known Chicago architect, the decor was inspired by the art forms of the Haida Indian tribe of the Queen Charlotte Islands, off the coast of British Columbia. The brilliant colors and striking design of the Haida sculpture, painting and weaving are faithfully translated in the basic decorative schemes of the Empire Builder's Great Domes.

Panels of unique linoleum carvings from the Haida culture provide intriguing focal points of interest in each car's decor.



**Luxurious reclining seats** with leg rests are provided on a reserved basis for 46 passengers on the lower level of each Great Dome coach. The dome deck seats 24, and reservations are not necessary.

